

- 1** Uřízneme hadici FLEXO pomocí řezáku.  
Cut the FLEXO hose using a cutter.
- 2** Nasadíme matici systému **H**.  
Attach the **H** system union nut.
- 3** Hadici FLEXO vložíme do lisu s čelistmi (CH) systému **H**.  
Insert the FLEXO hose into press with jaws (CH) of the **H** system.
- 4** Pertl vytvoříme lisováním 2 vln. Dodržujeme lisovací parametry.  
Create a flange by pressing 2 waves. Observe the pressing parameters.
- 5** Umístíme a zacvakneme C-klip za pertl.  
Place and secure the C-clip behind the flange.
- 6** Připraveno pro další použití. V případě dotazů, kontaktujte prodejce.  
Ready for further use. In case of any questions, contact the seller.

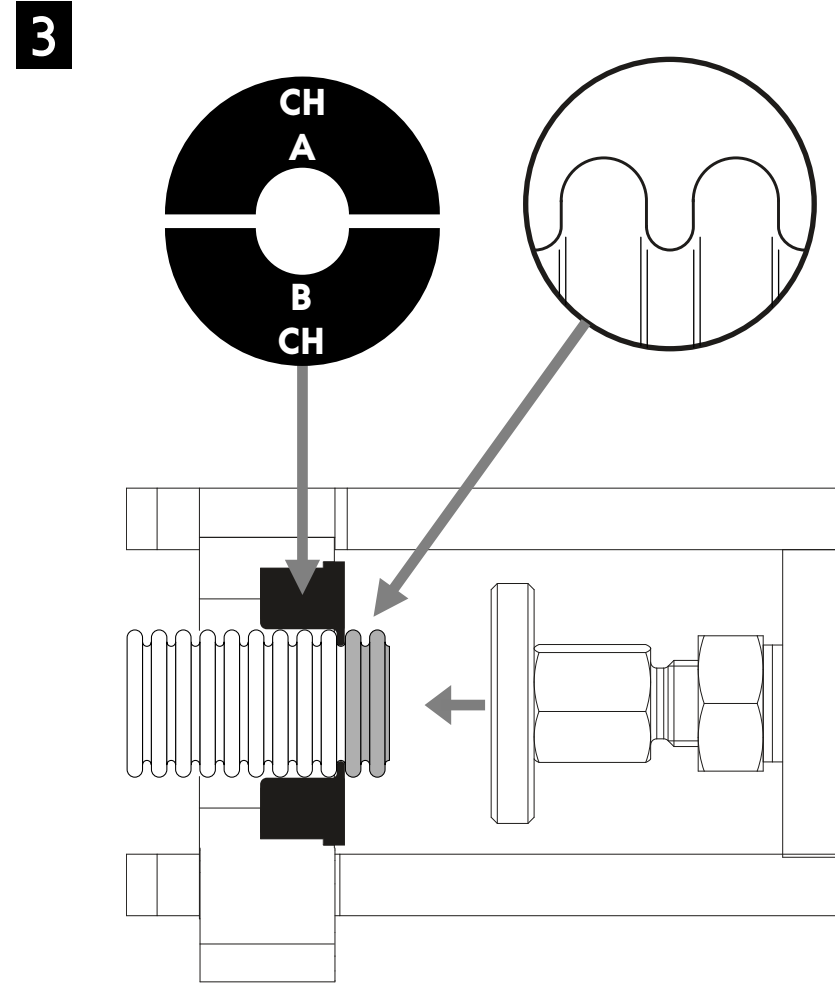

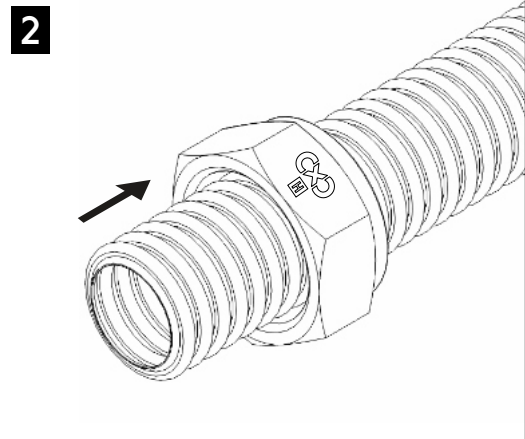

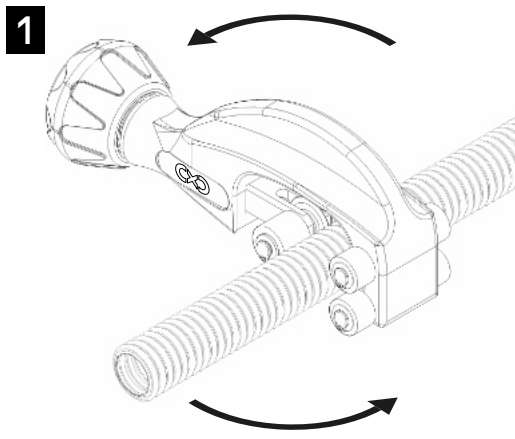

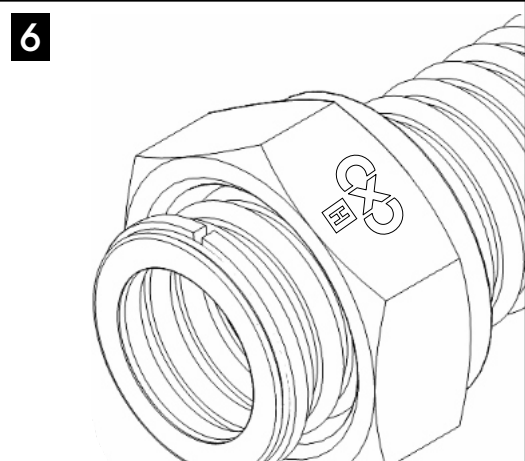
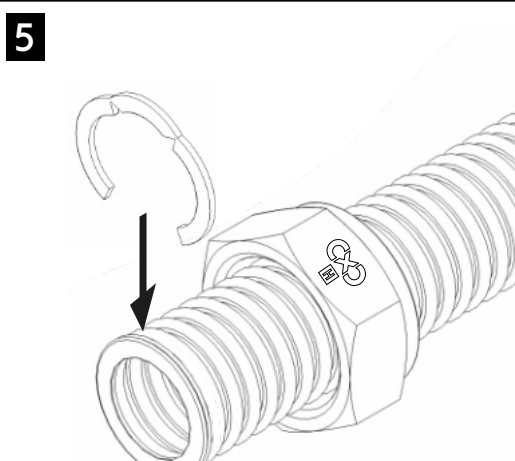
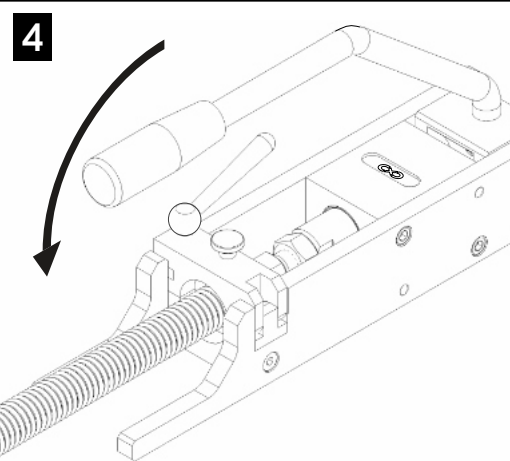
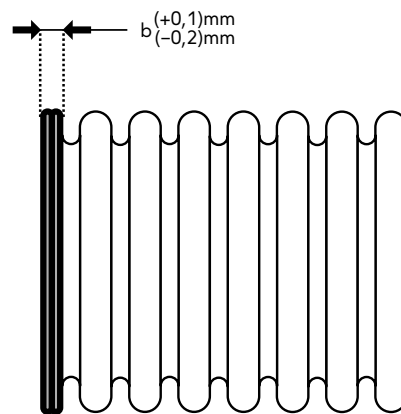

## Lisovací parametry Pressing parameters

Lis je přednastaven na trubku DN15.  
The press is preset for DN15.

DN	b [mm]
DN8	0,9
DN12	1,0
DN15	1,1
DN20	1,1
DN25	1,2



- 1** Uřízneme trubku pomocí řezáku.  
Cut a pipe using a cutter.
- 2** Nasadíme matici systému  & .  
Attach the  &  system union nut.
- 3** Trubku vložíme do lisu s čelistmi systému .  
Insert the pipe into press with jaws of the  system.
- 4** Pertl vytvoříme lisováním 3 vln.  
Dodržujeme lisovací parametry.  
Create a flange by pressing 3 waves.  
Observe the pressing parameters.
- 5** Připraveno pro další použití. V případě dotazů,  
kontaktujte prodejce.  
Ready for further use. In case of any questions,  
contact the seller.

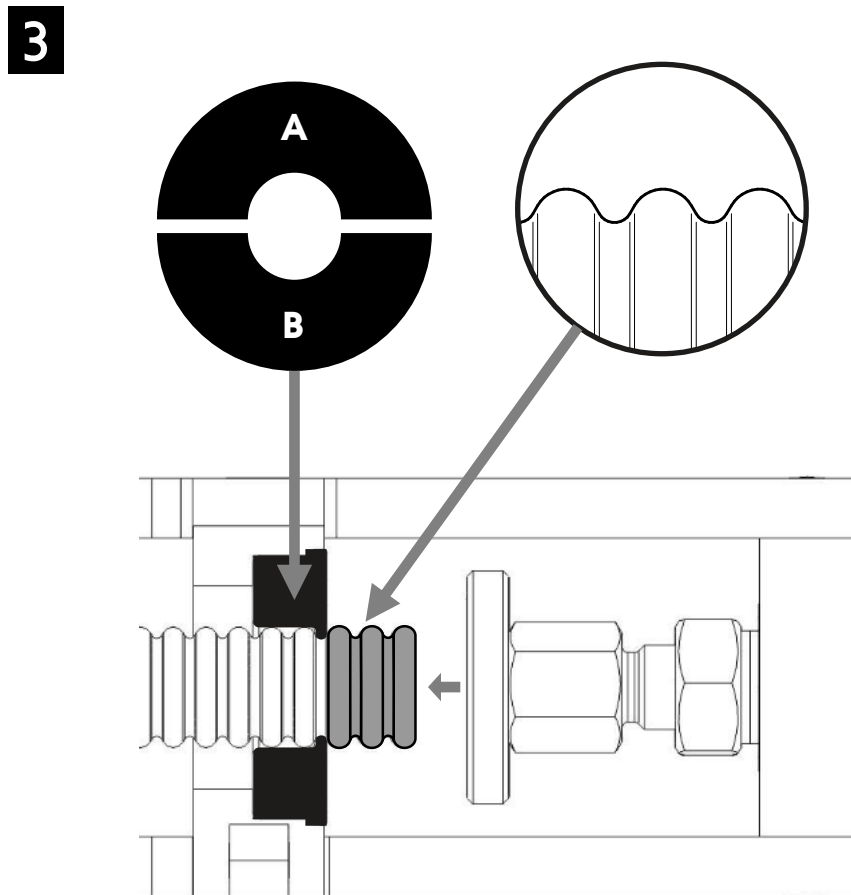
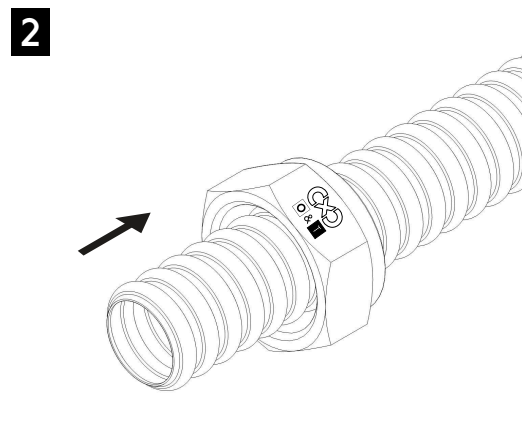
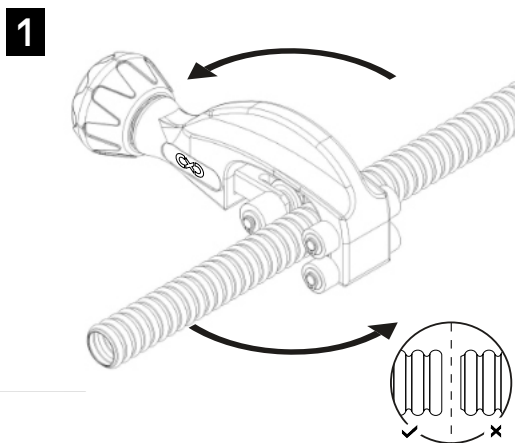

### Lisovací parametry

### Pressing parametrs

Lis je přednastaven na trubku DN15.  
The press is preset for DN15.

DN	b [mm]
DN8	2,1
DN12	2,8
DN15	2,8
DN18	2,8
DN20	3,1
DN23	3,2
DN25	3,2

